

Future Campus

RECOMMENDATIONS

The Facilities Plan for IVC presents an overall picture of the future developed campus. It includes recommendations for a series of site and facilities projects that are described in the pages that follow.

While drawings in the plan appear specific, the forms are conceptual sketches that highlight the location and purpose of recommended improvements. The final design of each site and facility project will take place as projects are funded and detailed programming and design take place with a designated user group.

In addition to the projects highlighted on this plan, additional upgrades are planned for existing buildings, including ADA upgrades and campus wide signage.

- EXISTING
- NEW CONSTRUCTION
- RENOVATION/CHANGE OF USE



Future Campus

PROJECT DESCRIPTIONS

Descriptions of key facilities projects are described on the following pages and grouped as illustrated in this key plan:

- A** Student Services
 - Student Union
 - Main Quad
 - B-200 Renovation
 - B-300 Renovation
- B** Instructional Building A
 - A-Quad
- C** PE-200 (Gym) Renovation
 - PE 100 Replacement
 - Wellness Court
- D** Student Housing
- E** M&O Complex
 - SAC Building Renovation
 - Arts Promenade and Coffee Structure
 - Baseball Team Room

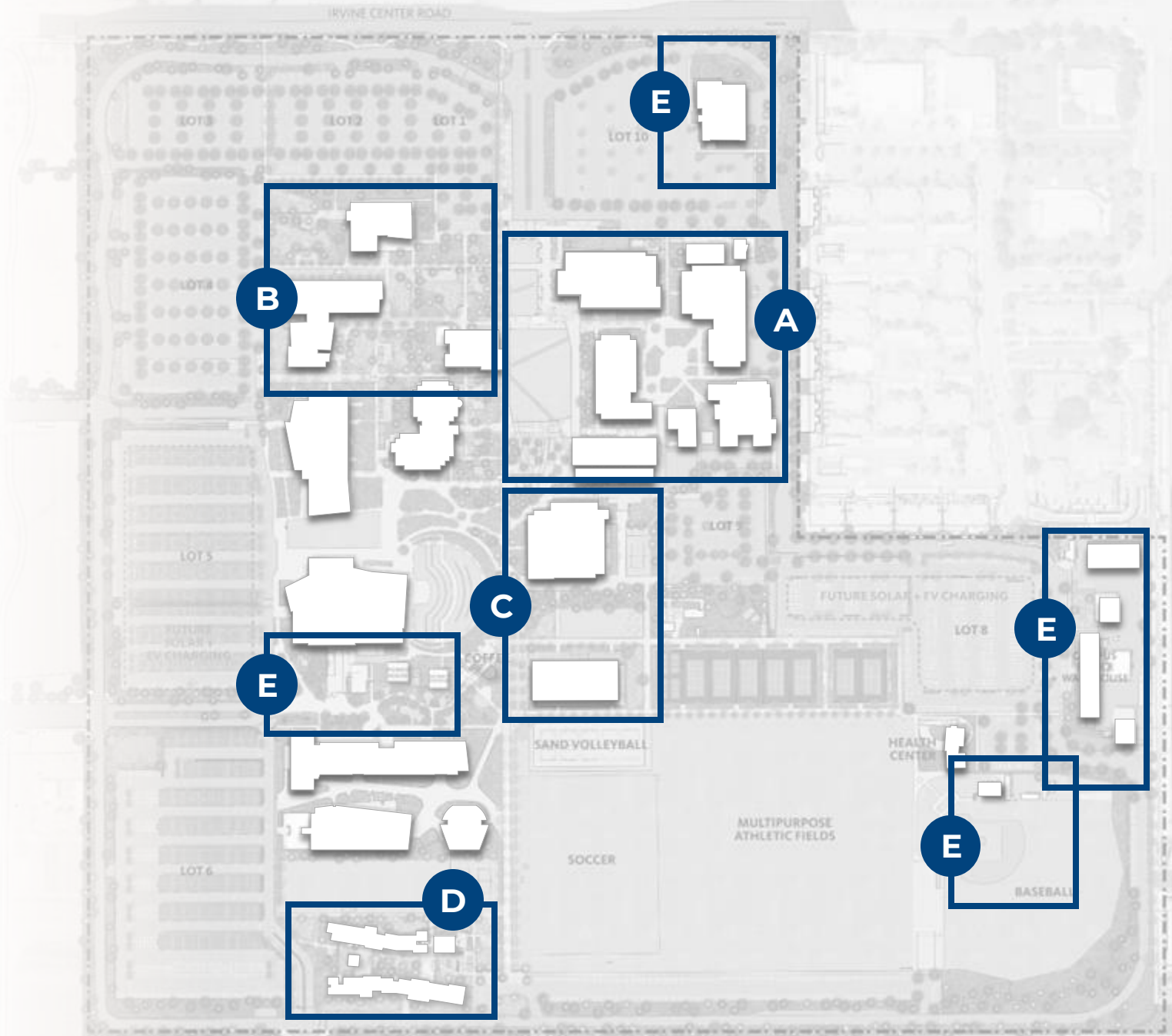

Future Campus A

PROJECT DESCRIPTIONS

Student Services

The new Student Services building will welcome visitors to Irvine Valley College and create a visible 'front door' to the campus. The building will house all first and second contact student support services in one location to increase access to the essential services that students need to be successful. Following the construction of the building, the existing SSC will be removed and the large quad will be developed as the new 'heart of the campus.'



Student Union

Across from the new Student Services building will be the companion Student Union building. Together, these two buildings will create bookends to the new campus heart and provide students access to expanded support services including the Bookstore, Food Services, the Food Resource Center, Student Activities, and the Student Equity Center. The location of the Student Union is strategically located along the Campus Promenade and serves as a bridge to the south portion of the campus.

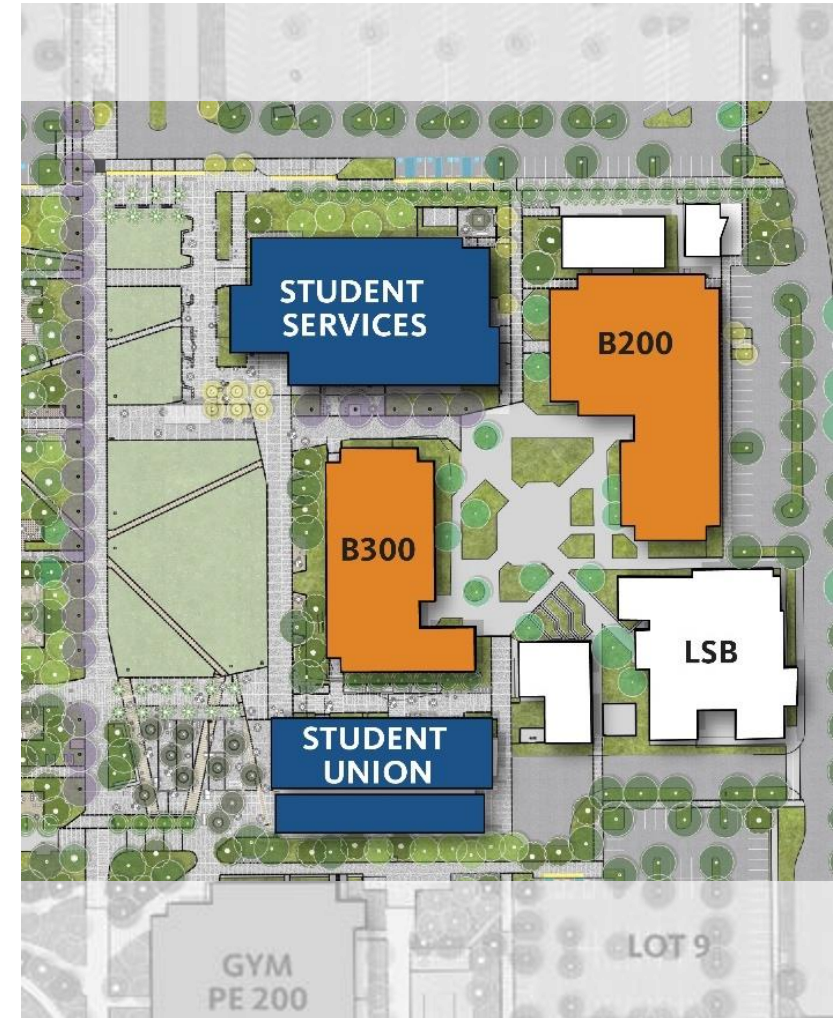

Future Campus

PROJECT DESCRIPTIONS

Main Quad

The Quad will be developed to create a new campus heart. Surrounded by core student support services, it will increase access to services and enhance campus engagement. Linked to a network of pedestrian paths, it will connect to all areas of the campus, bringing the campus community together to enhance a sense of belonging and build campus pride.

The space will be designed to support a variety of formal and informal activities in quiet and active zones. Active edges are developed adjacent to the Student Services and Student Union buildings and will be designed to support campus activities and outdoor seating/dining. Quiet study spots will support individual or small group collaboration. A large open area in the center will accommodate 4,000+ people for large campus events, graduation ceremonies, or casual play.

B200 Renovation

A series of improvements are planned for the B200 Building to address building deficiencies and to support program needs. The proposed improvements include the renovation of general classrooms and offices.

B300 Renovation

As functions move out of the B300 Building to new locations, space has been re-purposed to support the relocation of Marketing & Creative Services and the creation of the IVC Hub-Center for Professional Learning Programming. Additionally, planned renovations will include classrooms, labs, offices, and study/collaboration spaces to support Science and Math instructional program needs.

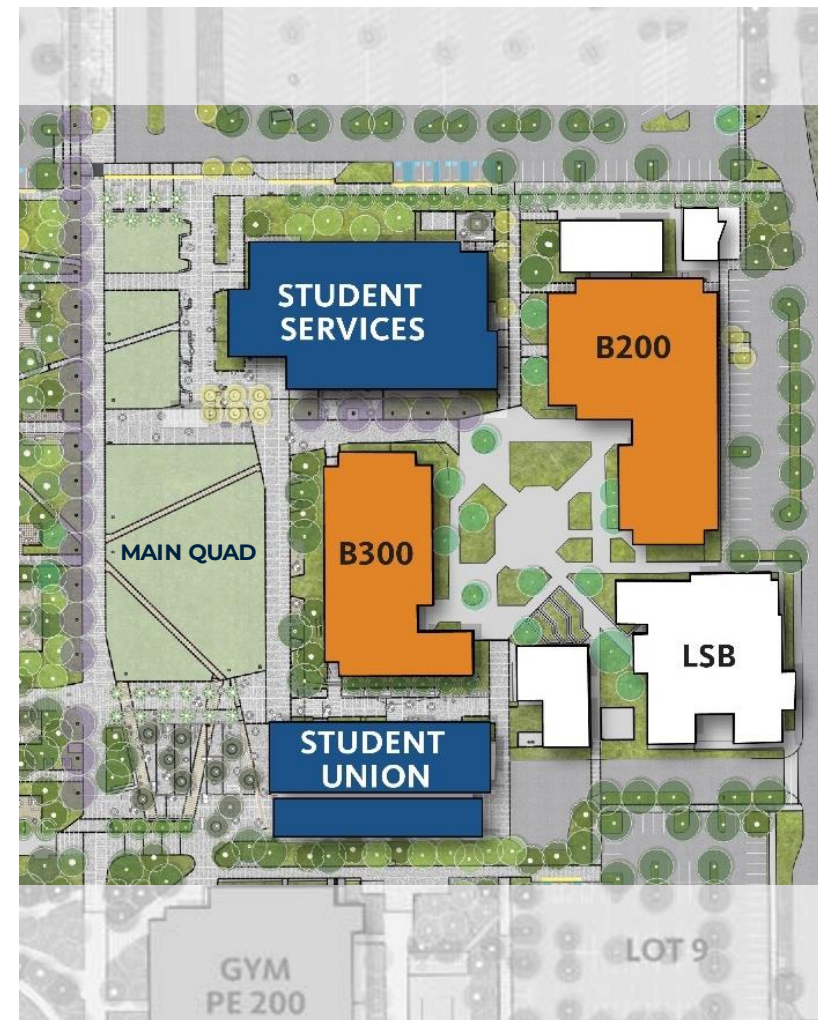

Future Campus **B**

PROJECT DESCRIPTIONS

Instructional Building A

A new multi-story Instructional Building will replace aged and under-performing facilities and be sized to support instructional program needs and replace administrative offices.

The new building will include interdisciplinary classrooms, labs and offices to support a variety of instructional programs (such as human development and psychology), support collaboration and improve the efficiency and utilization of space. In addition, the new building will include the President and Vice President's offices.

The placement of the new building will frame a campus entry point on the west side for improved access, and the renovated courtyard on the east side.

A-Quad

As the A-Quad buildings are replaced with new and modern facilities, the courtyard will be developed with places for students to meet, study, and socialize when not in class.

Pedestrian paths connect in the east direction to the Promenade and B-Quad, and a north-south path connects to the instructional areas to the south. The northwest corner of the A-Quad will be developed as a welcoming open area and pedestrian entry from parking.



Future Campus

PROJECT DESCRIPTIONS

PE 200 (Gym) Renovation

A comprehensive renovation is planned for the PE200 Building to address building deficiencies and to support program needs. In addition to supporting the functions currently housed within the building, the renovation will include space to support janitorial services.

PE 100 Replacement

A new physical education facility will replace the aged and under-performing PE100 Building. It will be sized to support program needs and address code requirements. The placement of the new building shifts to the south to be closer to the athletic fields and to free up space for the new Wellness Court.

Wellness Court

The Wellness Court is framed between the PE100 and PE200 Buildings and is planned to support both formal and informal outdoor instruction and recreation activities.

Formal areas are planned to support yoga, fitness, and other physical education activities. Informal spaces are planned for rest and relaxation, with shaded seating areas and a wellness garden.

The court includes a section of the Community Trail that meanders through the area. On the east side of the new PE100 Building, one tennis court will be removed and four new pickleball courts will be developed.

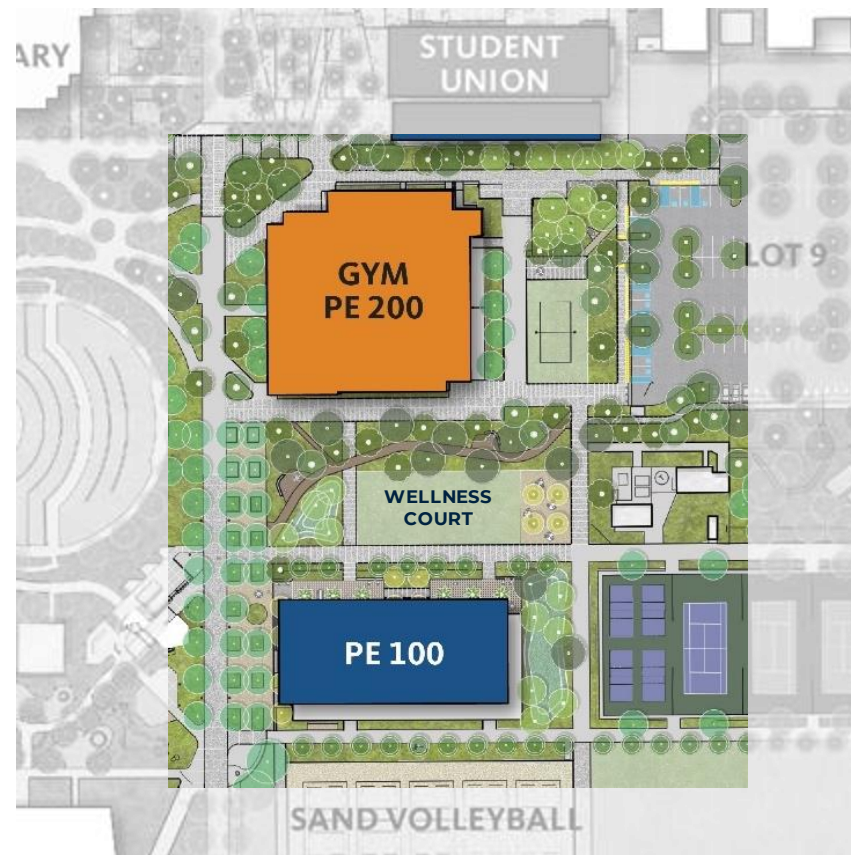

Future Campus D

PROJECT DESCRIPTIONS

Student Housing

The new IVC Student Housing Complex will serve 320 students in a mix of traditional single and double rooms and studio units and a one-bedroom apartment is planned for a full-time live-in Housing Director.

Community spaces include kitchens, laundry facilities, lounges and meeting rooms and are designed to encourage student engagement, individual and group study.

A large courtyard will include multiple gathering spaces and support a variety of events and activities.

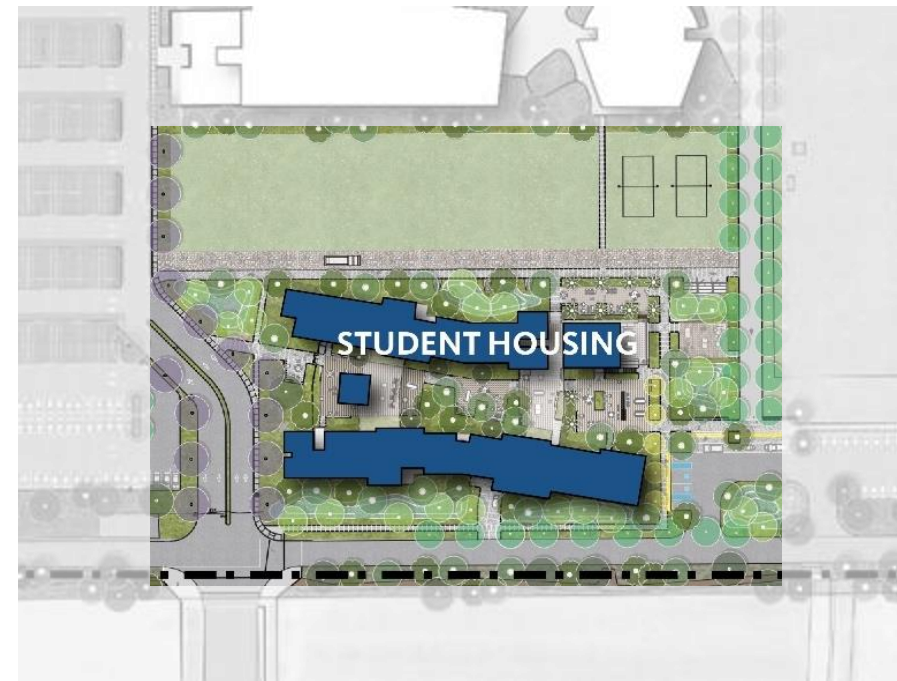

Future Campus E

PROJECT DESCRIPTIONS

M&O Complex

Proposed improvements for the M&O Complex include the replacement of existing portables with permanent structures.



SAC Building Renovation

Portions of the current SAC Building will move to the new Student Union and free up space for future programmatic needs.

The Basic Needs Center will remain in this location and continue to provide essential resources to students. Building will be renamed at some point.



Arts Promenade & Coffee Structure

An outdoor area is under construction which includes a new food service coffee establishment and an area for large outdoor "working" space with defined areas for sculpting, drawing, and painting; along with outdoor meditation and collaborative study spaces.



Baseball Team Room

This project will construct a team room for the baseball team at IVC.

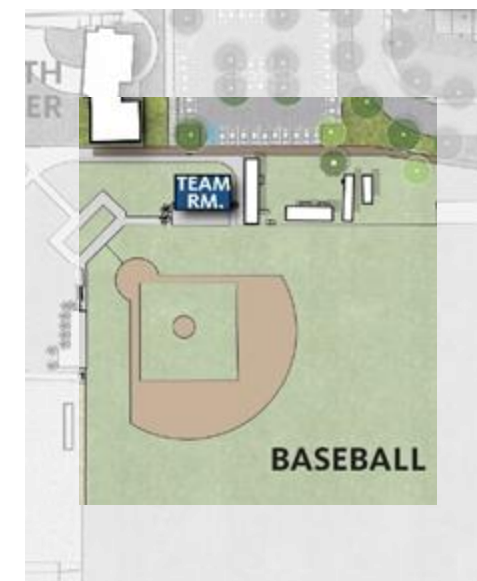

Future Campus

DEVELOPMENT CONCEPTS

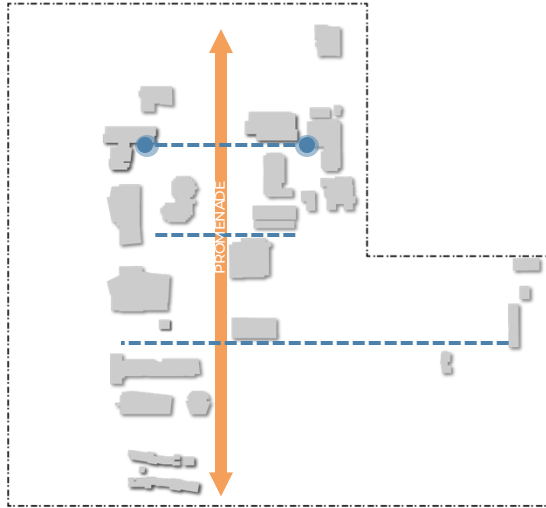

CONNECTIVITY is enhanced with clear pedestrian circulation patterns that connect all areas of the campus. A new pedestrian promenade serves as a major circulation spine from the new campus entrance to the future Student Housing.

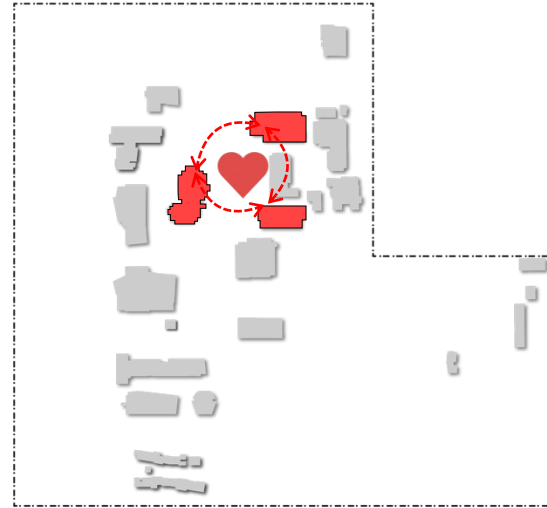

A CAMPUS HEART is created with an expanded central quad that is surrounded with core student support services. The central gathering space will create a center for student success and enhance the sense of community.

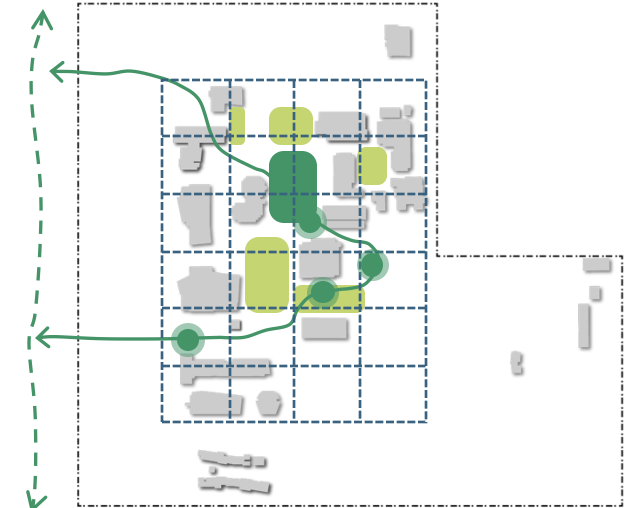

OPEN SPACES are developed to support outdoor studying and collaboration and enhance student engagement. A Community Trail connects to the future Jeffrey Open Space Trail and invites the community into campus. This organic trail interrupts the orthogonal grid of campus to create special moments of interest and activity along the way.

Future Campus

VEHICULAR EXPERIENCE

A series of vehicular recommendations are developed to improve clarity, connectivity and identity. Campus access points are developed to improve welcoming entries. The proposed distribution around the campus will reduce traffic and improve access to all areas of the campus.

A redesign of the main campus entry creates a formal welcoming experience and leads to a formal drop-off and new 'front door' to the campus at the Student Services Building. From the main drop-off, circulation extends to the loop and a new 'right-turn-only' exit is developed at the northeast corner of the campus. This will alleviate congestion and improve traffic flow.

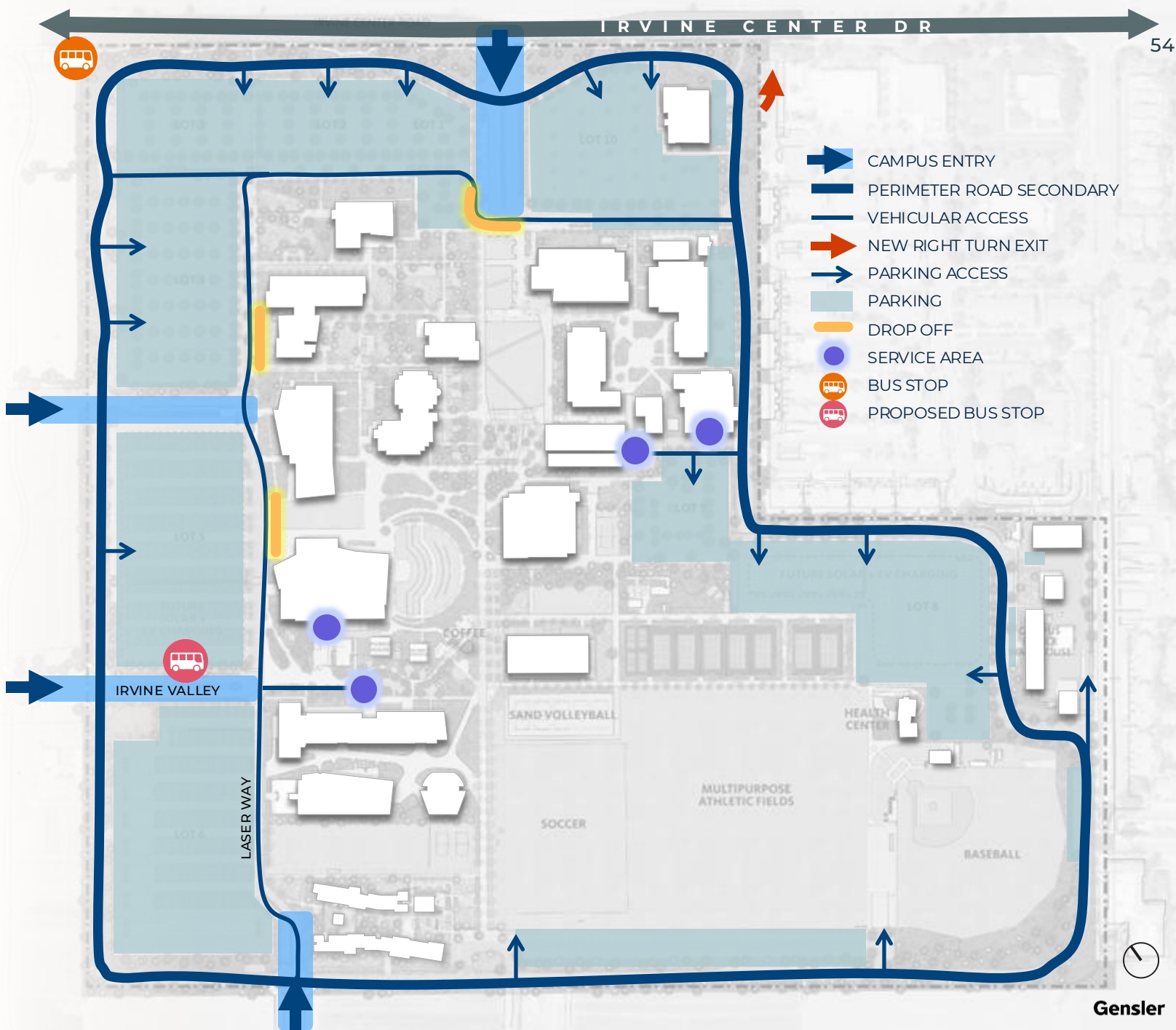

Future Campus

PEDESTRIAN EXPERIENCE

A clear network of pedestrian pathways is clarified and developed to improve access to programs and services, enhance wayfinding, and connect all areas of campus.

From the designated parking and drop-off areas, the framework extend north-south and east-west connecting all areas of the campus. The Promenade begins at the Main Campus Entry and extends to the southern-most part of the campus. Secondary pedestrian pathways branch off the main Promenade to create strong connections to all areas of campus.

The IVC Community Trail connects the Jeffery Open Space Trail to the campus core, inviting the surrounding community to experience the campus. It moves through the landscape as an experiential trail and includes rest spots to sit and appreciate the native landscape.

